



TERRAform*

garden adapted for people with reduced mobility

Collectif La Valise
1, rue Saint-Pierre
44000 Nantes, France
Tel : +33(0)251822187

contact@terraform.fr
<http://www.terraform.fr>

* Registered trademark

The idea of a garden adapted for people with reduced mobility was born from a meeting between the 'La Valise' group and the gardeners of the Prairie de Mauves meadows in Nantes.

Gardens and gardening have reputed qualities. They are a medium for social bonding and can help bring people out of isolation, can encourage the mixing of people of all abilities, as well as that of all generations, and fight the segregation which is often faced by handicapped people.



Principle

TERRAform is a package that will allow the independent (whether by individuals or groups) use of one or several allotments by people with reduced mobility.

This will involve having a special table made for grow boxes, which will be off the ground in order to allow people to work comfortably in the garden at 'table height'.

Thanks to its ergonomic shape, this table will allow gardeners to grow produce in full soil, while being face on with their work. The dimensions of the grow boxes have been calculated using arms' width, so that the gardener can comfortably reach the middle and the edges of the grow box without having to move.

The boxes can be joined together or kept separately, depending on the use and layout of the site.

The adjustable nature and the lightness of the material of these boxes allows for great flexibility and easier implementation, easy storage as well as great longevity.

Intended users

The **TERRAform** adjustable garden has been created especially for people in wheelchairs, or those for whom standing up is difficult, and for implementation within family gardens, retirement homes, care homes, schools and other specialised clubs and institutions for the disabled, hospitals, physical therapy centres and private gardens. **TERRAform** has been in business since 2010 in France and Europe.



Applications

Support for creation and hobbies, therapeutic activity (such as physical therapy and horticultural therapy) as well as for educational purposes (activities workshops or raising awareness of biodiversity...).



Technical specifications

The **TERRAform** casing is sold both separately or in a kit (with wooden partitions). The grow boxes can be set up in minutes and this does not require the use of any cleaning products or specialist tools.

Materials: The casing is made of polyethylene, both recycled and 100% recyclable, whilst the sides are made from Douglas-Fir, wood coming from French forests and treated via an oleothermic process. The **TERRAform** is compatible with organic and ecological farming.

Conception & marketing: La Valise association (Nantes)
Rotational plastics moulding: Rototec (Ile et Vilaine)
Carpentry: ATA0 rehabilitation workshop (Nantes)

Dimensions: Length : 150 cm / Width: 120 cm / Height: 80 cm / Volume: 0.8 m3 approx.

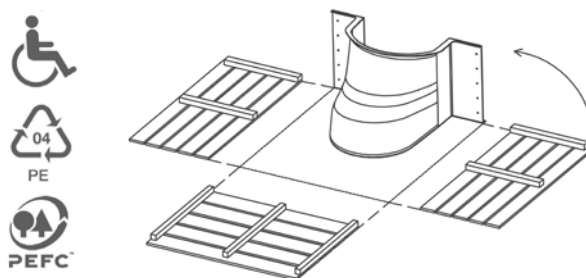

Quotes, conditions of sale, and additional information upon request

A project brought to fruition thanks to the support of:

The Chèque Déjeuner Foundation, The AG2R Foundation, The AGESICA Foundation, The Archipel des Utopies Association, Chiffolleau Printing House, The FONDES, The MACIF Foundation, The CCAH, The APRIONIS Group, The Mornay Group, Pays de la Loire regional council, Loire Atlantique general council, the Urban Community of Nantes.



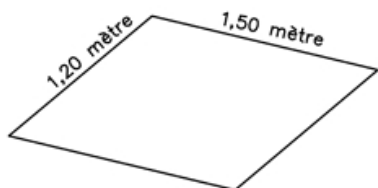

- ① The grow box must be positioned on ground that is stable, flat and level, with sufficiently well-draining soil. Set aside a rectangle-shaped area for the box, the sides of which measure 1.5 metres by 1.2 metres.

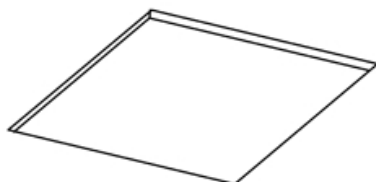

- ② If need be, dig up the surface to a depth of around 10 centimetres and replace it with a suitable draining material (gravel, coarse sand, clay marbles...) and level off.

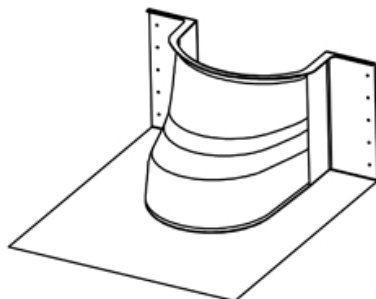

- ③ Position the polyethylene casing on the prepared surface.

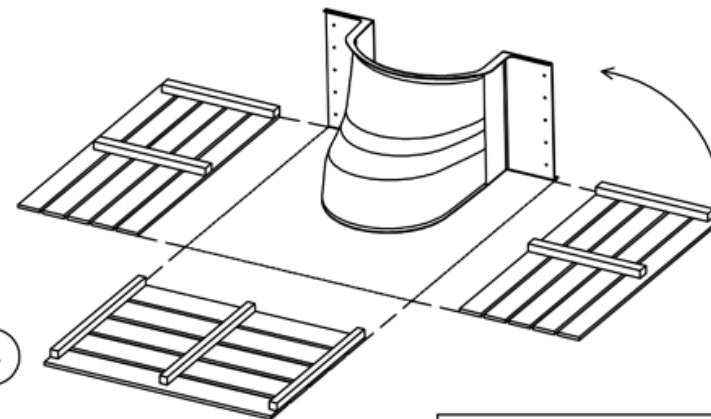

- ④ Put the flat sides in place, as indicated above.

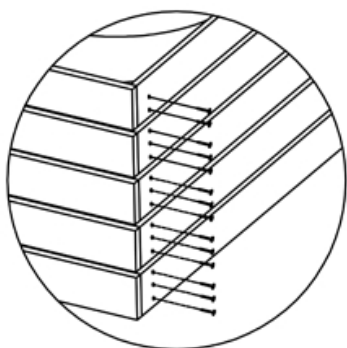

- ⑤ Fix the flat sides together with the help of the screws provided.

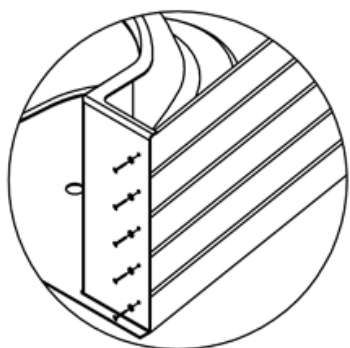

- ⑥ Adjust the flat sides to fit the casing and fix them firmly in place as indicated above using the screws and washers provided.

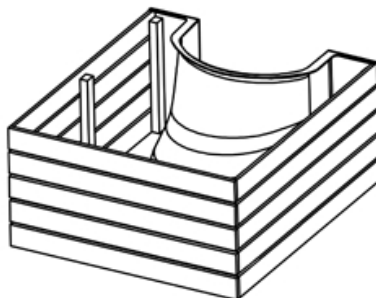

- ⑦ Check the structure is level before filling with soil.

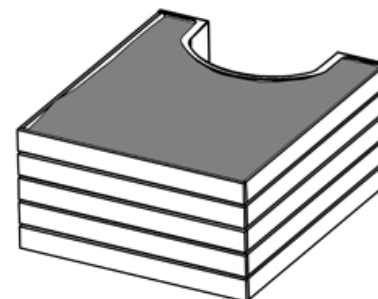

- ⑧ Fill the grow box with soil and compost, depending on what you plan on growing.

Advice:

In order to benefit from a composting effect (naturally providing its own heat and nutrients) and therefore producing a better yield, we advise that you fill the grow box in the following way, with successive layers:

- A core of coarse branches and soil, with well-packed mud.
- A litter layer of fine branches and soil, with well-packed mud.
- A layer of decomposing manure and decomposed foliage.
- A layer of coarse compost.
- A top layer of earth and fine compost.

It is then up to the client to make sure their garden is fully accessible and to consider the width and surfacing of paths, the positioning and location of grow boxes geared towards the type of growing you intend to do, as well as the abilities of those who will use the apparatus.

The client is solely responsible for the choice of products and their use, depending on the requirements they determined before placing their order, as well as the compatibility of their chosen products with those already used, which only they will know. This is entirely up to the clients; if they think they are not sufficiently competent, then they should seek advice.

The La Valise association rejects any complaints regarding destruction or deterioration resulting from normal wear and tear of the material and/or those resulting from improper use of the equipment.